

FIRST FLOOR PLAN

SCALE: 3/16" = 1'-0"

1

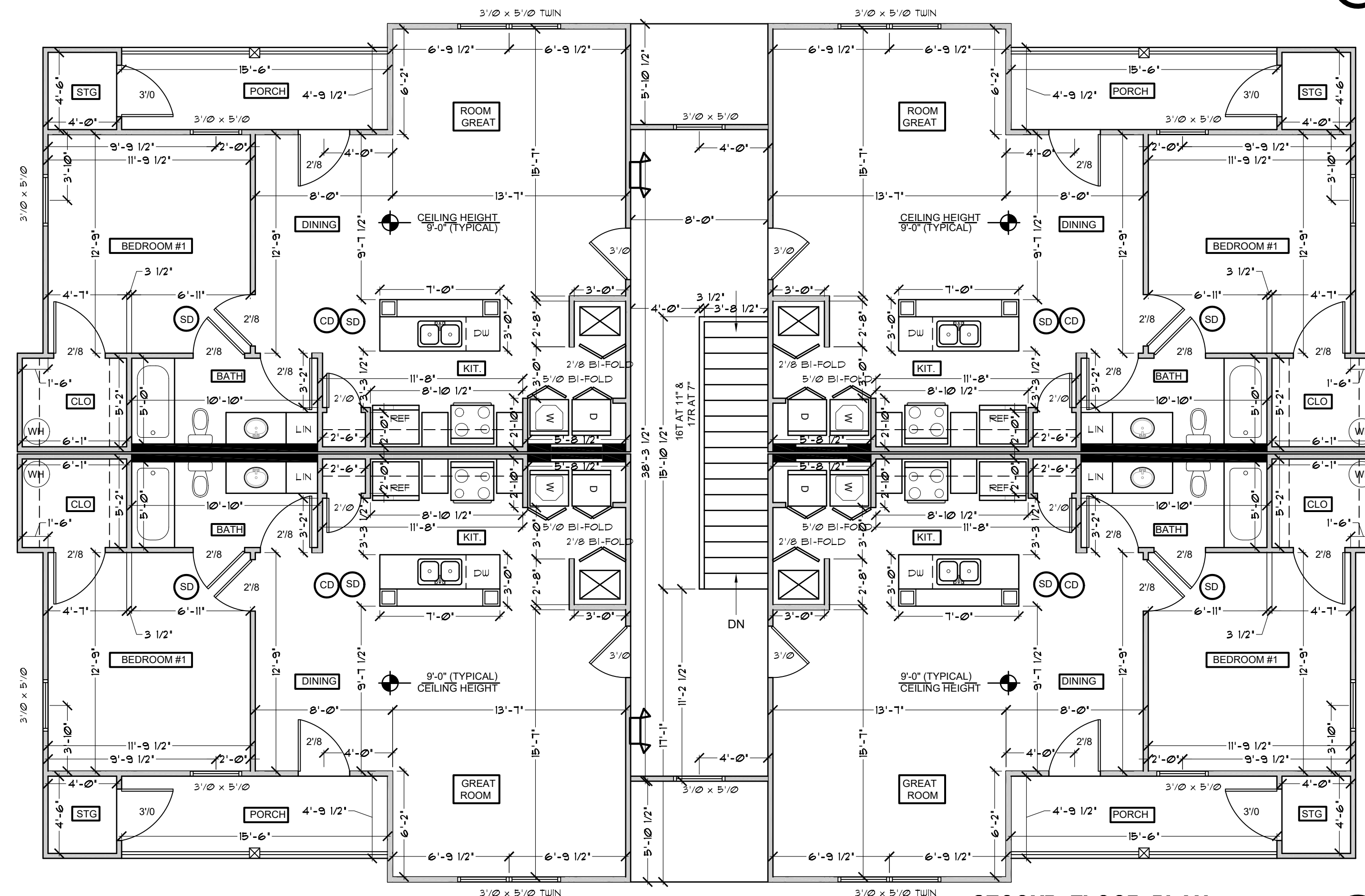

SECOND FLOOR PLAN

SCALE: 3/16" = 1'-0"

2

SD = SMOKE DETECTOR
 CD = CARBON MONOXIDE DETECTOR
 DUAL HEAD EMERGENCY EXIT LIGHT WITH BATTERY BACKUP.
 DUAL HEAD EMERGENCY LIGHT WITH BATTERY BACKUP.

COORDINATE ACCESSIBLE RAMP WITH ACTUAL SITE CONDITIONS. 1/2% SLOPE MAXIMUM. SEE CIVIL DRAWINGS FOR ACTUAL LOCATION.

FIRST FLOOR
 165 Sq. Ft. PER UNIT x 4 UNITS = 660 Sq. Ft.
 SECOND FLOOR
 149 Sq. Ft. PER UNIT x 4 UNITS = 596 Sq. Ft.
 TOTAL Sq. Ft. PER BUILDING = 1256 Sq. Ft.

REVISION #1 - 10/25/16
 * REMOVED TYPE 'A' UNIT TAG
 * REVISED DATE TO 2009 IN TYPE 'B' UNIT NOTES.



10/11/16

**8 PLEX BUILDING
 (ONE BEDROOM UNITS)
 FLOOR PLANS**

PROJECT NAME:
THE WOODS
 109 RIVERWOOD
 BOWLING GREEN, KY

WILLIAMS
 ASSOCIATE ARCHITECTS
 John Williams, Architect
 1136 South Park Drive - Suite 102
 Bowling Green, KY 42103
 270-782-2273 270-782-2173 Fax

WILLIAMS
 associates
 architects

REVISIONS:

PROJECT NO.

DATE: 10/06/16
 DRAWN BY: KJ
 CHECKED BY: JW

A-1